



TW4020 Wideband GPS Antenna

The TW4020 is a commercial grade wideband GNSS antenna covering the GPS L1, frequency band. It features a small patch element with 40% wider bandwidth than typical GPS L1 antennas.

The TW4020 features a high performance custom tuned ceramic patch element, 15 KV ESD circuit protection, a high gain two-stage low noise amplifier (LNA) with a mid-section high rejection SAW filter. It covers the GPS L1 and SBAS (WAAS/EGNOS/MSAS) frequency band (1572.5 to 1578 MHz), and it offers great circular polarized signal reception.

Even with the wider bandwidth, the TW4020 antenna is among the smallest high performance antenna available. It is housed in a compact IP67 magnetic mount enclosure, it comes with 3 metres of cable and a SMA connectors.

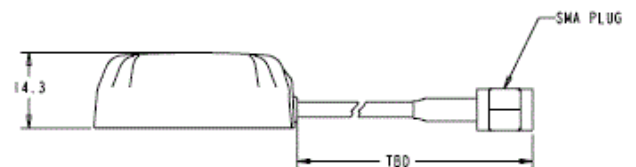
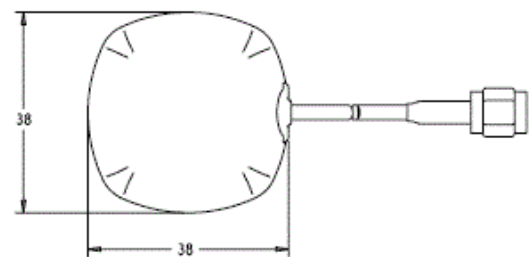

Applications

- Cost Sensitive Positioning
- Fleet Management & Asset Tracking
- Covert surveillance

Features

- 40% wider bandwidth, small footprint
- Axial ratio: 6 dB max (GPS)
- Low noise LNA: 1 dB
- High rejection SAW filter
- High gain: 28 dB typ.
- Wide voltage input range: 2.5 to 16 VDC
- IP67 weather proof housing

Benefits

- Increased system accuracy
- Excellent signal to noise ratio
- RoHS compliant
- Ideal for harsh environments
- Excellent out of band signal rejection



TW4020 Wideband GPS Antenna

Specifications

Antenna

Architecture	Wideband Single Feed Patch
1 dB Bandwidth	31 MHz
10dB Return Loss Bandwidth	45MHz
Antenna Gain (with 100mm ground plane)	4.5 dBic
Axial Ratio over Bandwidth (over full bandwidth)	4dB @ Fcenter, 6 dB max

Electrical

Architecture	LNA stage 1 -> SAW filter-> LNA stage 2
	Filtered LNA Frequency Bandwidth 1565 to 1585 MHz
Polarization	RHCP
Gain	28dB min., 1575.42 MHz
Gain flatness	+/- 2 dB, 1575 to 1606 MHz
Out-of-Band Rejection	<1500 MHz -45dB (typical) <1550 MHz -25dB (typical) >1640 MHz -40dB (typical)
VSWR (at LNA output)	<1.5:1
Noise Figure	1 dB typ.
Supply Voltage Range (over coaxial cable)	+2.5 to 16 VDC nominal
Supply Current	12 mA max.
ESD Circuit Protection	15 KV air discharge

Mechanicals & Environmental

Mechanical Size	38mm x 38mm dia. x 14.3mm H
Connectors	SMA male, others available
Cable	RG174 / 5 metres, other lengths optional
Operating Temp. Range	40 to +85 °C
Enclosure	Radome and base: ASA plastic
Weight	73g (enclosure 34gm, 3m cable 39gm)
Attachment Method	Magnetic
Environmental	IP67 and RoHS compliant
Shock	Vertical axis: 50 G, other axes: 30 G
Vibration	3 axis, sweep = 15 min, 10 to 200 Hz sweep: 3 G
Warranty	One year, parts and labour

Ordering Information

TW4020 – Wideband GPS Antenna, 3 metre cable, SMA Male

32-4020-0

Tallysman Wireless Inc

106 Schneider Road, Unit 3
Ottawa ON K2K 1Y2 Canada
Tel 613 591 3131
Fax 613 591 3121
sales@tallysman.com

The information provided herein is intended as a guide only and is subject to change without notice. This document is not to be regarded as a guarantee of performance. Tallysman Wireless Inc. hereby disclaims any or all warranties and liabilities of any kind. © 2012 Tallysman Wireless Inc. All rights reserved.

Rev 1.2